

# Upholstered Wooden Commode

Product Code: COMM-WOOD-F

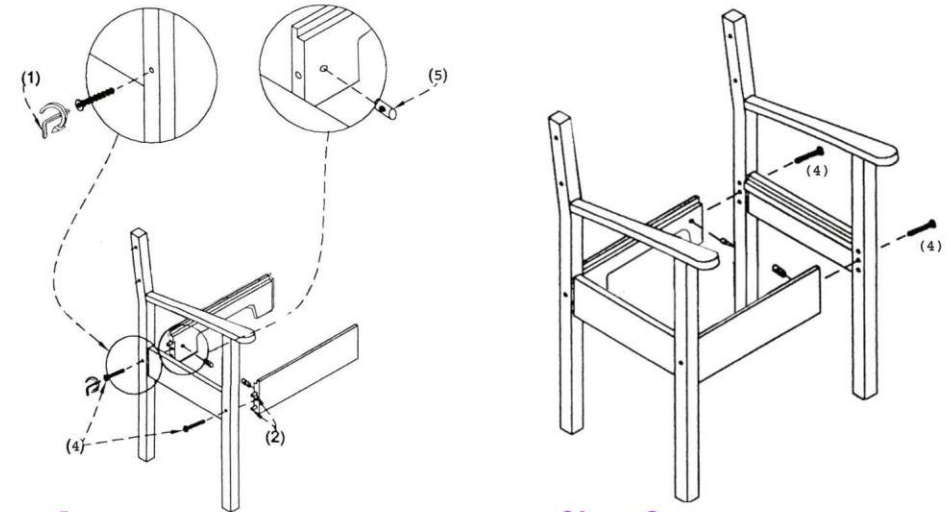

## Assembly Instruction

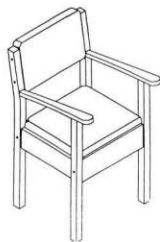

### Step 1.

Insert 2 Dowels (2) and 1 Barrel Nut (5) into each end of front (11) and back (10) panels. Insert 60mm JCBC (4) screws through side panel (8) and tighten with Allen Key (1).

### Step 2.

Repeat Step 1 with right side (9).

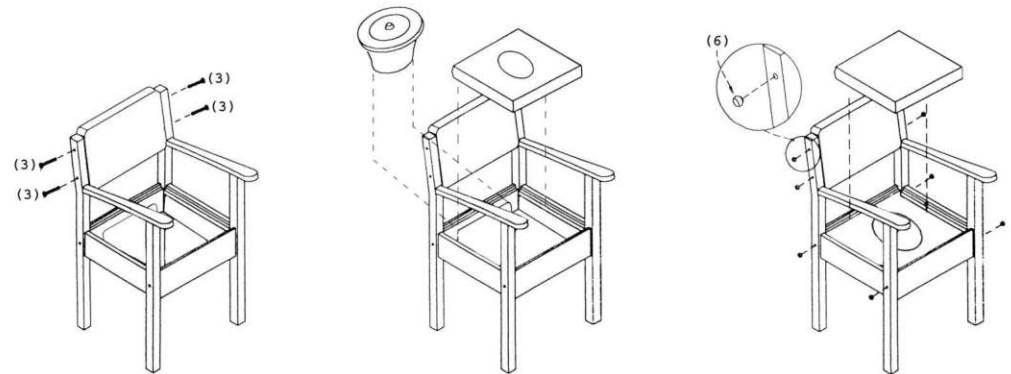

### Step 3.

Fit the back rest (12) to the sides by using 4 pcs of 6x45mm JCBC screws (3).

### Step 4.

Place the fibre glass seat (14) on top of the frame.

Insert bucket (7) from the rear of the commode into the retaining clips on the underside of the seat (14), as far as the rubber stopper.

### Step 5.

Insert the wooden buttons (6) into the screw holes.

Place the upholstered seat (13) in place on top of fibre glass seat (14).

|                                      |  |  |  |  |   |  |
|--------------------------------------|--|--|--|--|---|--|
| <p>Allen Key<br/>x 1<br/>(1)</p>     | <p>Dowel<br/>(10x45mm)<br/>x 8<br/>(2)</p> | <p>JCBC Screw<br/>(6x45mm)<br/>x 4<br/>(3)</p> | <p>JCBC Screw<br/>(6x60mm)<br/>x 4<br/>(4)</p> | <p>Barrel Nut<br/>(6x13mm)<br/>x 4<br/>(5)</p> | <p>Wood Button<br/>(Wood)<br/>x 8<br/>(6)</p> | <p>Bucket &amp; Lid<br/>x 1<br/>(7)</p>  |
| <p>Left Side Leg<br/>x 1<br/>(8)</p> | <p>Right Side Leg<br/>x 1<br/>(9)</p>      | <p>Back Panel<br/>x 1<br/>(10)</p>             | <p>Front Panel<br/>x 1<br/>(11)</p>            | <p>Back Rest<br/>x 1<br/>(12)</p>              | <p>Seat<br/>x 1<br/>(13)</p>                  | <p>Fibre glass<br/>Seat x 1<br/>(14)</p> |